

# Regulated DC Power Supply

## User Manual

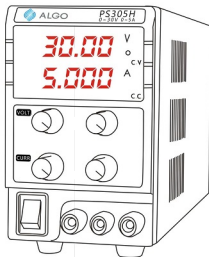

PS303  
 PS305  
 PS3010  
 PS603  
 PS605

PS303H  
 PS305H  
 PS3010H  
 PS603H  
 PS605H

Dear Clients,

Thank you for using our power supply. We are committed to giving you the best product available today and we take the safety using and palatable using very seriously. Our power supply allows you to have a stable and accurate output as your device or load exactly needed. At safety concerns, we encourage you to read this manual thoroughly and follow the suggestions carefully below for prolonging the service life of the product.

Please keep this instruction manual in case you may need it at any time in the future. Thanks again for choosing our products and service.

## Know the device:

Algo regulated power supply is a simple, accurate DC power source with full indicated power. It provides power source for factory maintenance, calibration positions, and can be integrated into test&equipment cabinet. It powers the DIY circuit in our work bench at home and is also a necessary tool for educational institute particularly for those involve electronics and telecommunications majorities.

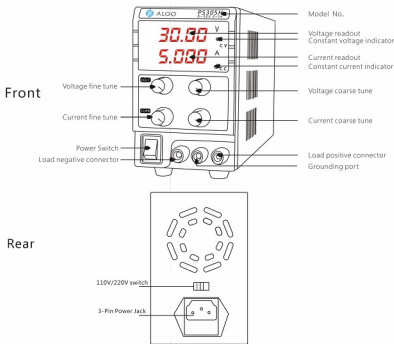

# Features and Technical Specifications

## a. Features:

High as 80% power efficiency

A secondary voltage stabilization circuit through MOS ensuring a superb voltage output

Full angle protection include overload,overheating, Overvoltageo, Short-circuit Protection etc.

Small size as 3U high appropriately fit for work station or test equipment cabinet.

## b. Technical Specifications:

Model	Output Voltage (V.)	Output Current (A.)	LED Display (digit)
PS303	0~30	0~3	3
PS303H	0~30	0~3	4
PS305	0~30	0~5	3
PS305H	0~30	0~5	4
PS3010	0~30	0~10	3
PS3010H	0~30	0~10	4
PS603	0~60	0~3	3
PS603H	0~60	0~3	4
PS605	0~60	0~5	3
PS605H	0~60	0~5	4

### **GENERAL INFO.**

Dimension: 226\*82\*138mm

Net Weight: 1.8kg

Working temperature: 0 ~ 40°C

Relative humidity: ≤ 80%

Fuse: F5AL, 250VAC

### **VOLTAGE REGULATION**

Regulation rate: ≤ 0.05% + 3mV

Load regulation rate: ≤ 0.1% + 3mV (Rated Current ≤ 3A)

≤ 0.1% + 5mV (Rated Current > 3A)

Ripple and noise: ≤5mVrms (5Hz ~ 1MHz)

### **CURRENT REGULATION**

Regulation rate: ≤ 0.2% + 3mA

load regulation rate: ≤ 0.2% +6mA

Ripple and noise: ≤ 10mArms

Restore: ≤ 300μs (with load of 50% regulation rate, 0.5A )

### **HIGH VOLTAGE**

Leak current: ≤1mA (with input 1500VAC/1s to ground)

Insulant resistance: ≥5MΩ (with input 500VDC/5s to ground)

### **RESTORE CONDITIONS**

Temperature: -10 ~ 70°C

Relative humidity: ≤ 70%

## Operation Instruction

- (1) Turn the 110V/220V switch at rear panel of power supply to a correct position according to your local voltage standard.
- (2) Plug into 110V or 220V indoor power source.

- (3) Use a wire with one end in Ground Port and another end to earth.
- (4) Press "Power Switch" to turn on the device. Coarsely or fine tune the voltage knob to get a desired voltage to your load.
- (5) Turn off the power by pressing the "Power Switch", short out "positive connector" and "Negative Connector" with a wire.



- (6) Press "Power Switch" to turn on the device. Coarsely or fine tune the current knob to get a wanted current. And then remove the wire.
- (7) Connect a load, positive to positive port (green), negative to negative port (black).

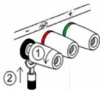

Loose



Fasten

## For Safety Use

We suggest to follow the suggestions below very carefully.

- The device is intended for indoor use only
- It's very important to turn the power switch (110V/220V) at real panel to a correct position according to your local voltage standard.
- Do not open or repair the device or it will void the warranty.
- Do not use the device in a damp environment.
- Keep the device away from heat or water, magnetic field.
- Keep the device and all loose parts (if any) away from children, pets and unauthorized persons.
- Don't sharply bend, cut, extend, knot, step on or pull the cord but on the plug when disconnecting the power cables.
- When the device is damaged in any way, stop using it immediately.
- If the device is not in service for long, unplug the power.
- Use the spare parts with same specification as original one.



Algo Electronics Co.,Ltd All Rights Reserved  
 4th Fl, Xinzetong Industrial Zone, No. 85 Xintang, Guanlan, Longhua, Shenzhen  
[www.algoelectronics.com](http://www.algoelectronics.com) Tel: 86-755-23222680